

# SPARE PARTS

- |  |                                       |
|--|---------------------------------------|
| 01. Right shoulder                         | 45. Lower scraper                     |
| 02. Left shoulder                          | 46. Lower scraper tightening spring   |
| 03. Right panel                            | 47. Lower Scraper positioning segment |
| 04. Left panel                             | 48. Spacer                            |
| 05. Flange                                 | 49. Pinion Z=16 3/8"                  |
| 06. 6004 2RS bearing                       | 50. A56 V-belt                        |
| 07. Seeger ring                            | 51. Pulley                            |
| 08. Spacer                                 | 52. Right connecting rod              |
| 09. Free wheel                             | 53. Spacer                            |
| 10. Threaded pinion                        | 54. Shaft for lifting                 |
| 11. Double-threaded screw                  | 55. Shaft for connecting rod movement |
| 12. Double crown Z=16 1/2" x 1/8"          | 56. Bolt                              |
| 13. Idle crown Z=16 3/8                    | 57. Handle return spring              |
| 14. Spacer                                 | 58. Seeger ring                       |
| 15. Spacer                                 | 59. 6005 2RS bearing                  |
| 16. Lever end stop segment                 | 60. Chain tensioning crown            |
| 17. Lever end stop                         | 61. Chain tie rod                     |
| 18. Flywheel                               | 62. Chain tie rod spacer              |
| 19. Washer                                 | 63. Lifting Shaft Bushing             |
| 20. Toothed segment                        | 64. Motor pulley                      |
| 21. Handle                                 | 65. Electric motor                    |
| 22. micro-switch Manual movement inversion | 66. Bed                               |
| 23. micro-switch plate                     | 67. Belt tie rod                      |
| 24. Spring                                 | 68. 6001 2RS bearing                  |
| 25. Bushing for Connecting rod             | 69. Belt tensioning cylinder          |
| 26. Guard lifting rod                      | 70. Conveyor belt                     |
| 27. Cylinder moving lever                  | 71. Underbed                          |
| 28. Guard closing micro-switch             | 72. Extension for underbed            |
| 29. Guard rod                              | 73. Surface fulcrum rod               |
| 30. Bushing                                | 74. Underbed locking flywheel         |
| 31. Left connecting rod                    | 75. Surface support                   |
| 32. Upper scraper shaft                    | 76.                                   |
| 33. Upper scraper                          | 77. Fork for rolling pin              |
| 34. Upper shaft cover                      | 78. Belt tensioning shaft             |
| 35. Spacer                                 | 79. Panel for Electric system         |
| 36.  | 80. Base                              |
| 37. Shield                                 | 81. Motor support                     |
| 38. micro-switch spacer                    | 82. Shield stop                       |
| 39. Manual movement activation control rod | 83. Shield stop                       |
| 40. Manual control rod knob                |                                       |
| 41. Left belt drive cylinder               |                                       |
| 42. Fixed cylinder                         |                                       |
| 43. Right belt drive cylinder              |                                       |
| 44. Mobile cylinder                        |                                       |

# SPARE PARTS

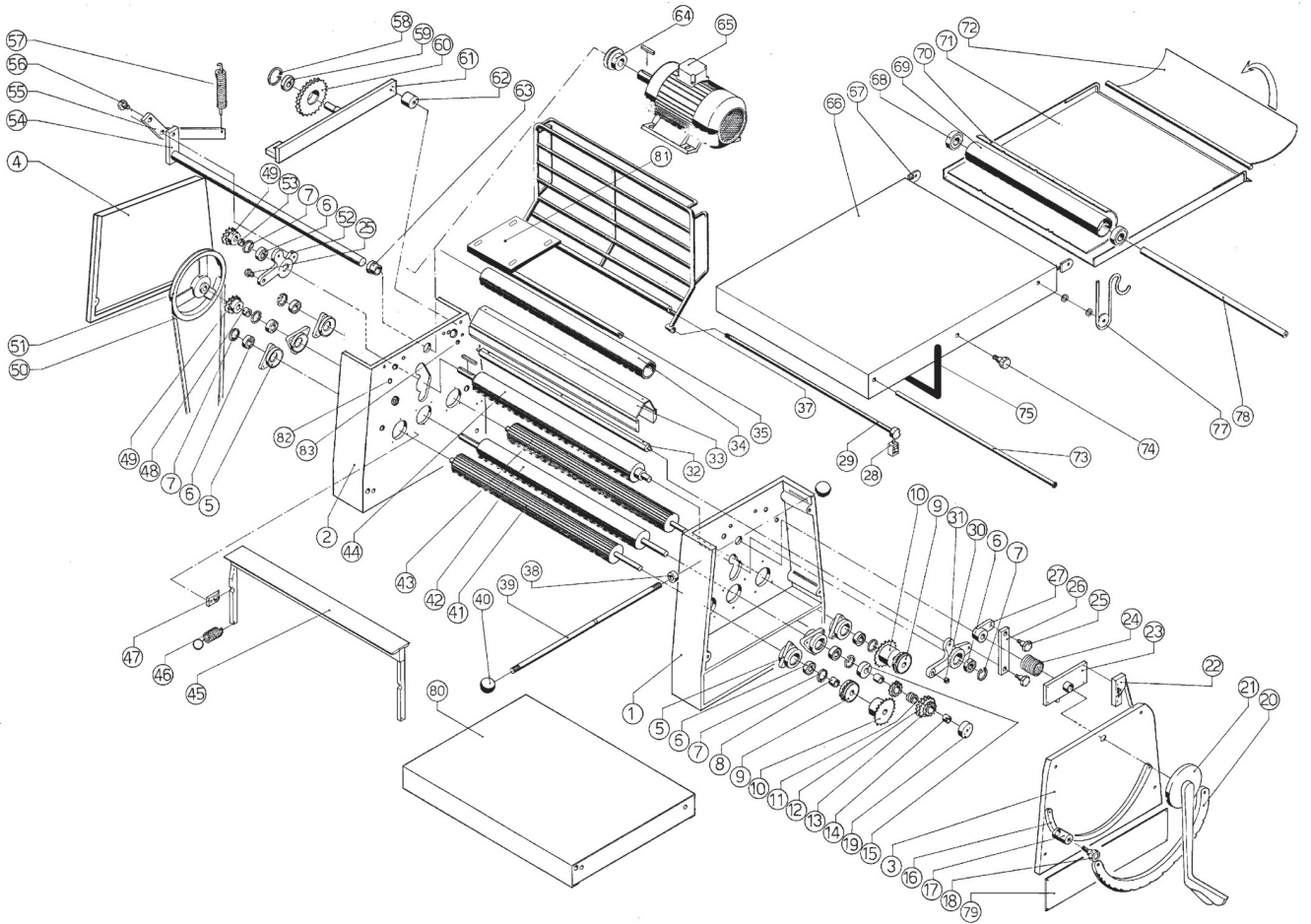

MADE IN ITALY